

Truly unique

PEOPLE AND PRODUCTS

in Level Measurement Technology

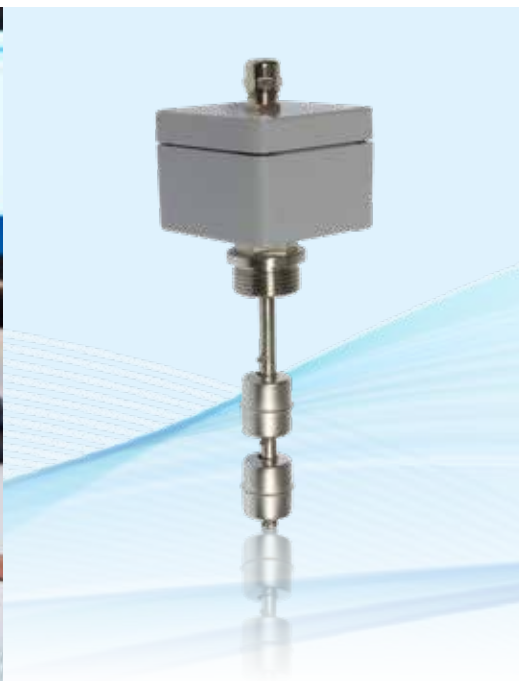

Truly unique LEVEL MEASUREMENT TECHNOLOGY

Jacob GmbH has been founded in 1922 and is well-known for high-quality solutions in electro-technical components. Since 1986, also in Level Measurement Technology.

R&D, process development and manufacturing are all located under one roof at our headquarter in Kernen, Germany. This leads to technical solutions that are as unique as those who have created and implemented them.

FACTS

- ▶ 1986 Foundation of Jacob Level Measurement Technology in Kernen, Germany
- ▶ Development, Manufacturing and Sales of high-quality customized Level Measurement Technology Solutions
- ▶ Portfolio: Float Switches, Level Sensors, Optical Sensors, Suction Lances, Radar Sensors, Ultrasonic Sensors, Capacitive Sensors



FLOAT SWITCHES - 8MM AND 12MM SKID PIPE

straight and angled

Material	Process connection	Electrical connection	Contacts	Overall length	Temperature range	Pressure	Protection grade	Options
PVC PP Stainless steel Brass	G1/8" to G1", Flange (round and oval)	PVC- and Silicone-cable, M12-connector, Alu- and ABS-enclosure	Max. 4 NO/NC, Max. 3 change over	Up to 2.000 mm	-40 °C to +150 °C	Max. 3 bar	Up to IP67	Integrated RTD on request

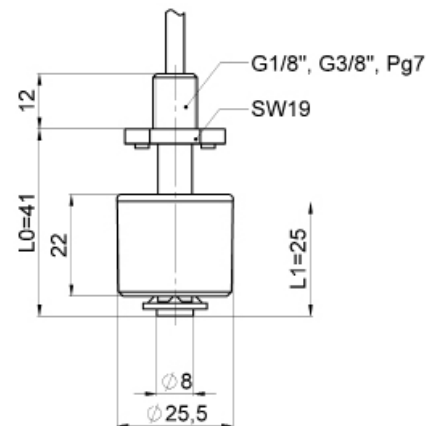

FLOAT SWITCHES - 8MM AND 12MM SKID PIPE

straight and angled

Material	Process connection	Electrical connection	Contacts	Overall length	Temperature range	Pressure	Protection grade	Options
PVC PP Stainless steel Brass	G1/2" to G2", Flange (round and oval), others on request	PVC- and Silicone-cable, M12-connector, Alu- and PS-enclosure	Max. 4 NO/NC, Max. 3 change over	Up to 2.000 mm	-40 °C to +150 °C	Max. 3 bar	Up to IP65	Integrated RTD on request

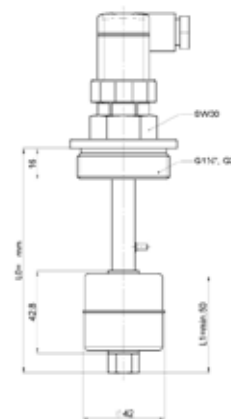

INCAPSULATED FLOAT SWITCHES

with protective pipe

Material	Process connection	Electrical connection	Contacts	Overall length	Temperature range	Pressure	Protection grade
Brass PVC	G3/8" and G1"	PVC- and Silicone-cable	Max. 2 NO/NC, Max. 1 change over	Up to 2.000 mm	-40 °C to +80 °C	Max. 3 bar	Up to IP64

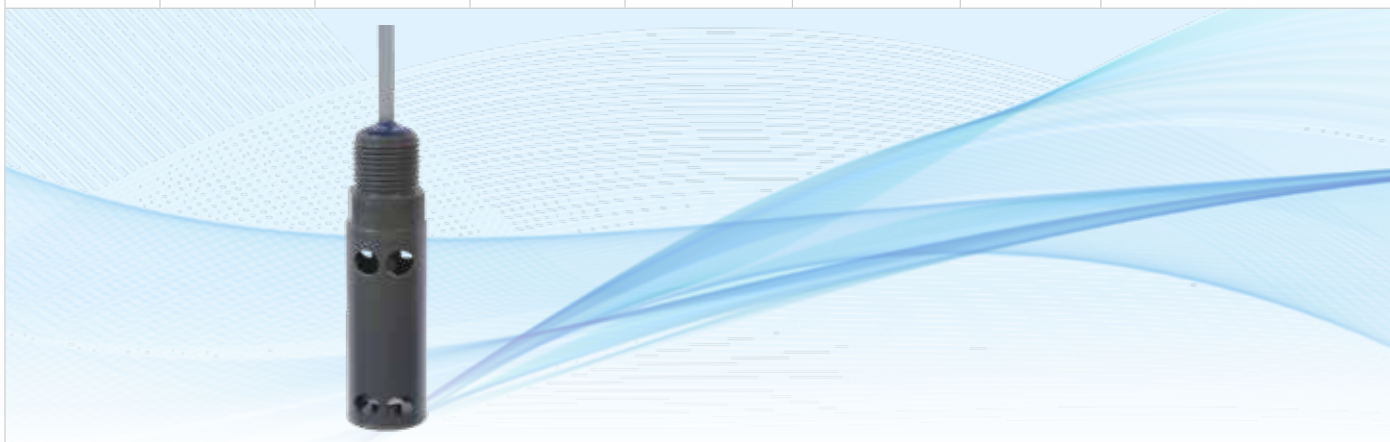

BYPASS FLOAT SWITCHES

Material	Process connection	Electrical connection	Contacts	Overall length	Temperature range	Pressure	Protection grade
Aluminum Stainless Steel	G3/8"	Aluminium-enclosure	Max. 4 NO/NC, Max. 3 change over	Up to 1.000 mm	-40 °C to +150 °C	max. 10 bar	Up to IP65

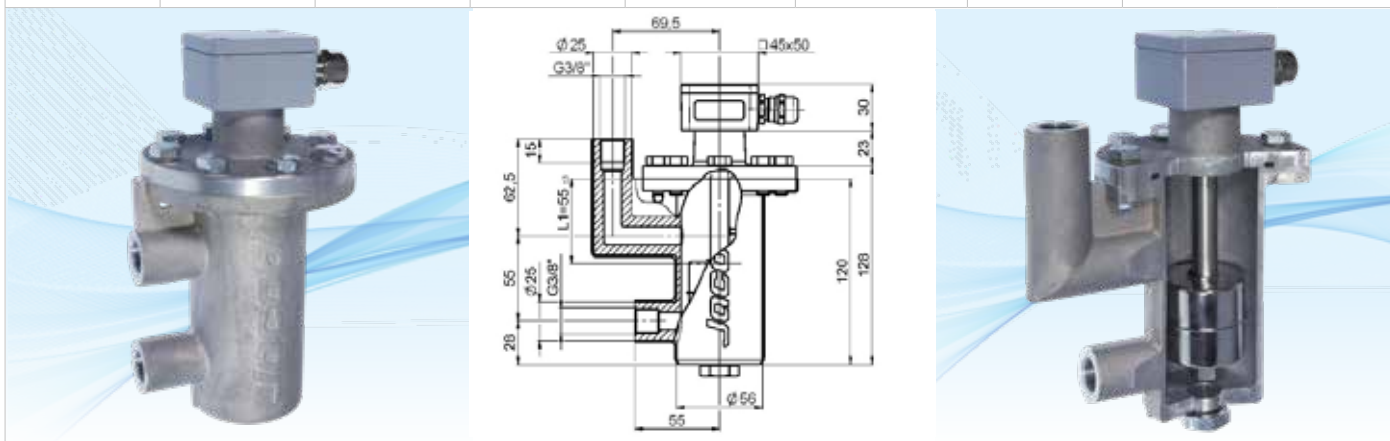

LEVEL SWITCHES

fully enclosed

Material	Electrical connection	Contacts	Switching current	Temperature range	Protection grade	Option
Polypropylen (PP)	2 to 30 m cable	1 change over	10 A (250 VAC), 4 A (30 VDC)	0 °C to +60 °C	Up to IP68 (40 m)	without counterweight

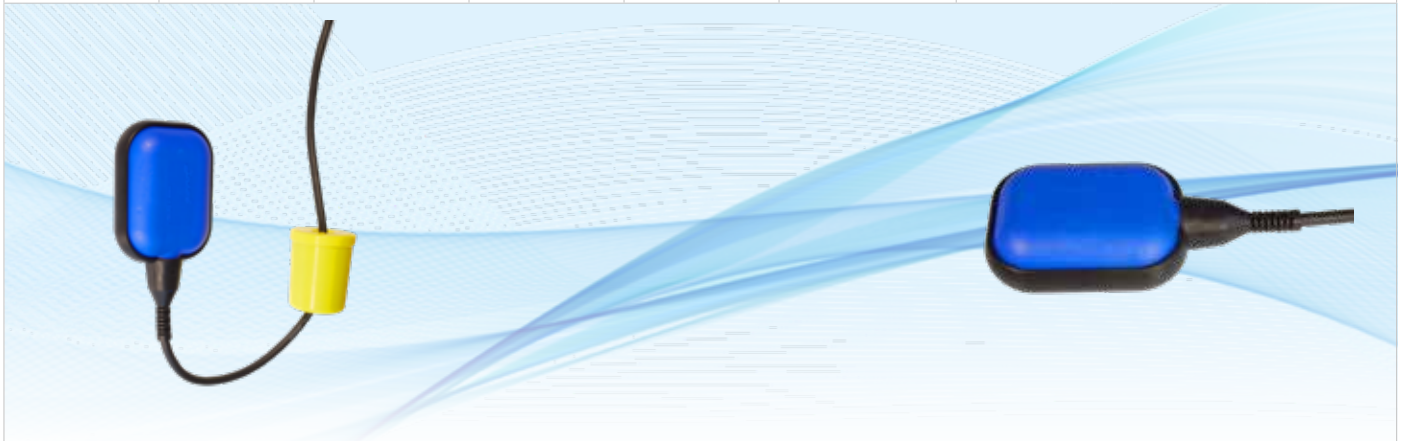

PLASTIC FLOAT SWITCHES

for horizontal installation

Material	Process connection	Electrical connection	Contacts	Temperature range	Pressure	Protection grade
PVDF	M16x2 and 1/2" NPT	PVC-cable	1 NO, NC or change over	Up to +70 °C	max. 3 bar	Up to IP65

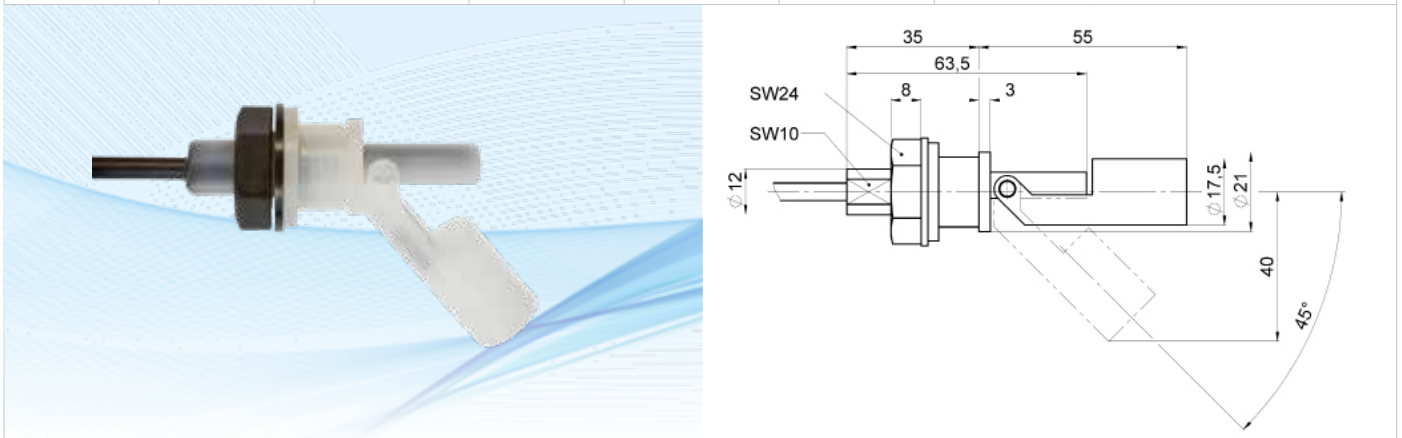

Flexible Manufacturing - **IN ANY QUANTITY**

Our Level Measurement Technology Solutions are as individualistic as you are.

For us, development and production are inextricably linked. The solutions are specifically tailored to our customers. This is mirrored in the flexibility of our manufacturing processes - we are able to realize both large and small series up to customer-specific one-off productions.

We supply to companies in many different industries. Therefore, the applications and technical framework conditions are different for each product. On our hands, we have various materials and manufacturing processes to translate our customers' requirements into product solutions.

ERICH PANTEA
HEAD OF SENSOR PRODUCTION

„The strength of our production lies in the extremely high flexibility. We realize a large variety of products. And we have the ability to customize the products in a straightforward and uncomplicated way.“



EDUARD DÜRBACH
QUALITY ASSURANCE

„When it comes to quality, there can be no compromises.“





Linie 2

LEVEL SENSORS

for continuous measurement

Material	Process connection	Electrical connection	Resolution	Overall length	Temperature range	Pressure	Protection grade	Options
PVC PP Stainless steel	From G3/8" to G2", flange (round and oval), others on request	PVC- and Silicone-cable, M12-connector, Alu- and ABS-enclosure	Grid: 5 or 10 mm	Up to 2.000 mm	-40 °C to +80 °C	max. 30 bar	Up to IP65	4-20mA transducer or integrated RTD on request

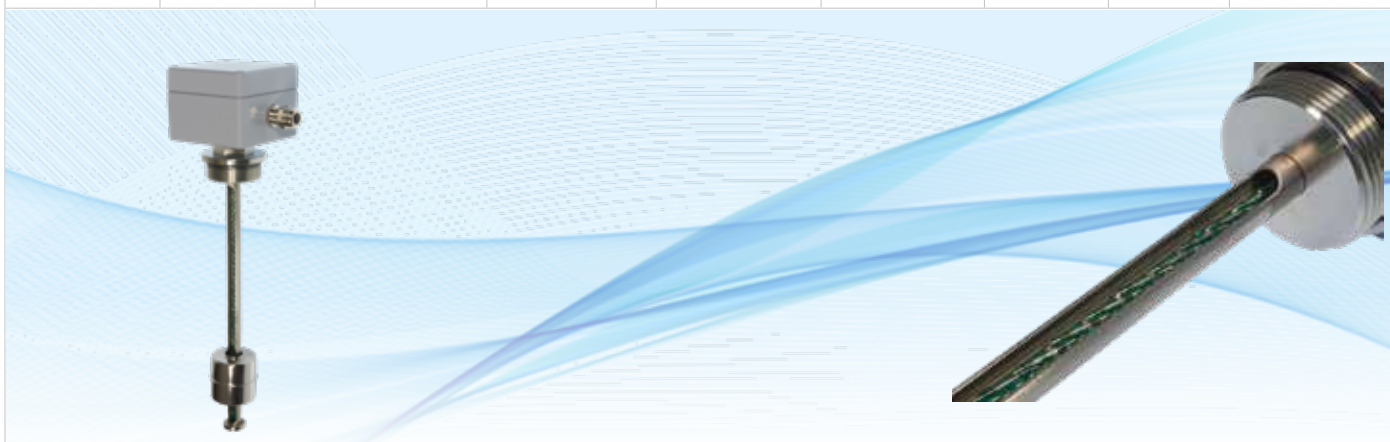

OPTICAL SENSORS

Material	Process connection	Electrical connection	Function	Output	Temperature range	Pressure	Protection grade
Polysulfone Stainless steel	M12, G3/8", G1/2", NPT	PVC-cable, M12-connector	NO in air, NC in air	PNP, NPN open collector	Up to +125 °C	Up to 60 bar	Up to IP67

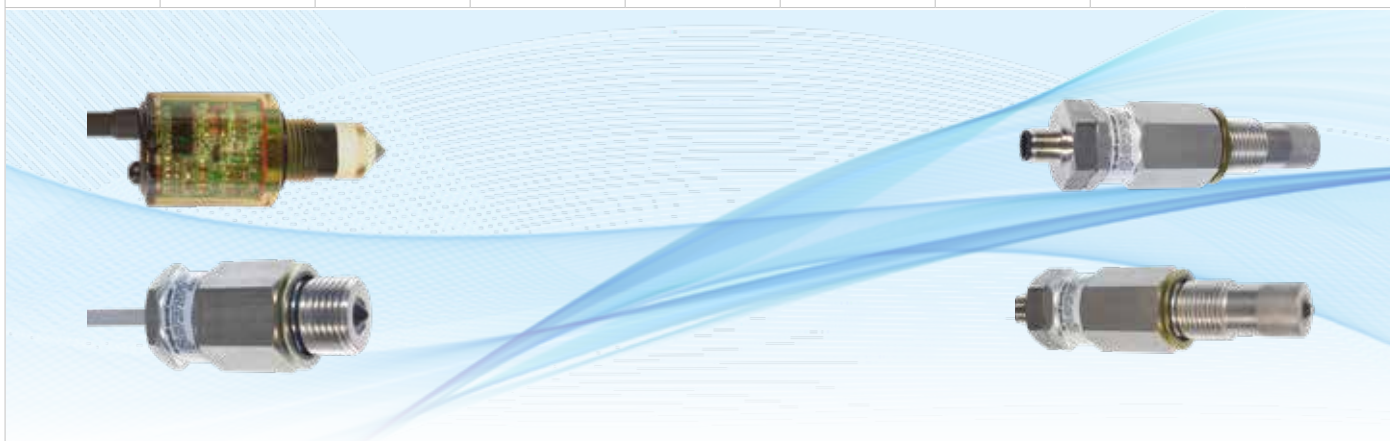

SUCTION LANCES

combination of float switch and suction tube

Material	Process connection	Electrical connection	Contacts	Overall length	Temperature range	Pressure	Protection grade	Options
PVC PP-float	G1 1/2" to G2", Screw cap, Plug in flange, others on request	PVC- and Silicone-cable, ABS-enclosure	Up to 3 NO, NC or 2 change overs	Up to 1.500 mm	0 °C to +60 °C	0 bar	Up to IP64	Non return valve

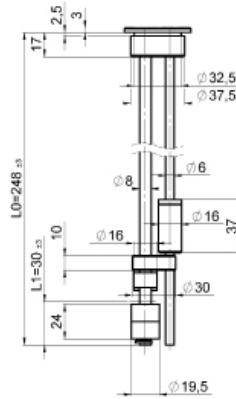
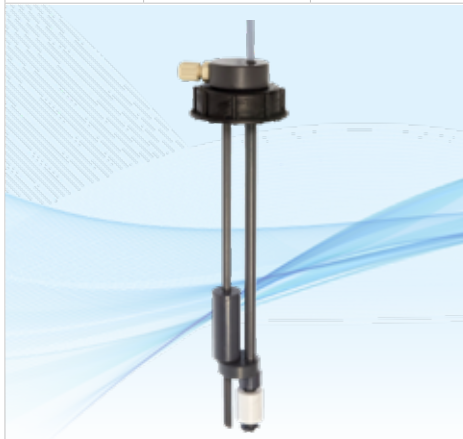

MAGNETIC SWITCHES IN THE ROUND HOUSING

Material	Housing	Electrical connection	Contacts	Overall length	Temperature range	Protection grade	Options
PA Stainless steel Brass Nickel plated brass	Ø8 and 12 mm/ threads M8, M10, M12, Pg7	PVC- and Silicone-cable, M12-connector	1 NO/NC, change over	30 to 100 mm/ above 100 mm on request	-40 °C up to +150 °C	Up to IP65	bistable switching characteristic

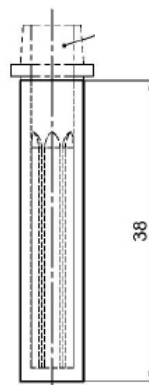
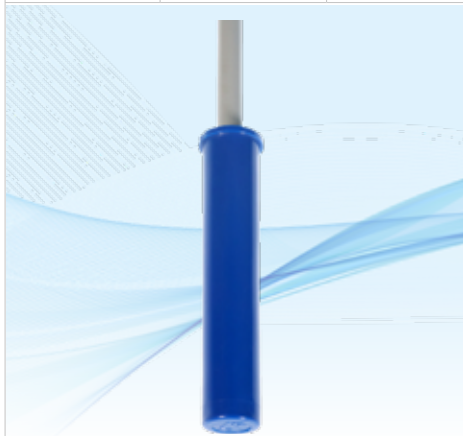

MAGNETIC SWITCHES IN THE FLAT PACK

Material	Housing	Electrical connection	Contacts	Temperature range	Protection grade	Options
PA	35 x 13 mm to 80 x 35 mm	PVC- and Silicone-cable, M12-connector	1 NO or NC, change over	-40 °C to +110 °C	Up to IP65	bistable switching characteristic

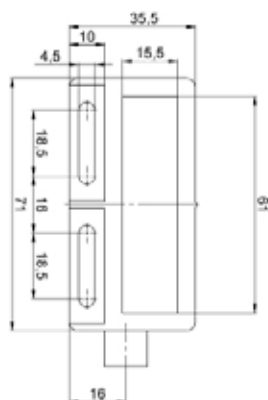

PERMANENT MAGNETS

for switching our magnetic switches

Housing	Characteristic	Options
Available in different housings	Axial or radial aligned to reed-contacts	Permanent magnet also available without housing

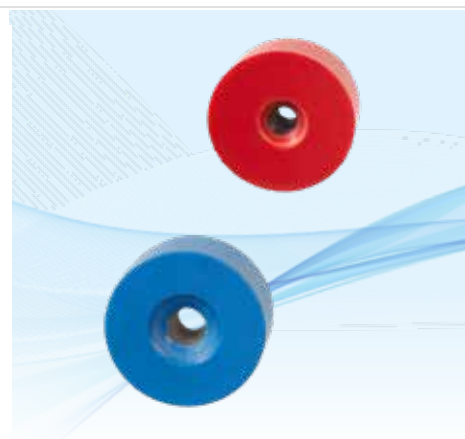
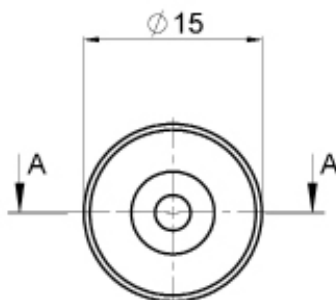

Local and global: **CUSTOMER FIRST**

It is attitudes that shape the way we work together - in private as well as in business. It is part of our conviction that we do not impose any ready-made solutions on our customers. On the contrary: the customer is our top priority - together we find solutions to tricky problems where others have long since given up.

We take every challenge seriously and fully engage with each customer project. Thanks to the cooperation with our international partners, we can provide our solutions almost anywhere around the globe.

GIULIANA DESSUPOIU
SALES

„It is my aim to offer every customer friendly and competent advice in all matters.“



Phone +49 (0)7151 4011-66
giuliana.dessupoiu@jacob-gmbh.de

ROBERT NEUMANN
SALES MANAGER

“In your projects we focus on your requirements. I take the time for on-site visits and detailed project discussions. Rely on our experience and know-how.”



Phone +49 (0)7151 4011-9402
robert.neumann@jacob-gmbh.de



Applications

WITHOUT

LIMITS



ULTRASONIC LEVEL METERS JLMU-53

Supply voltage	Output type (var. „I“)	Output type (var. „U“)	Output type RS-485 (var. „M“)	Temperature error	Temperature range	Process connection	Protection class
18 ... 36 V DC	4 ... 20 mA (2-wire)	0 ... 10 V (3-wire)	Protocol modbus RTU	max. 0,04 % /K	-30 °C ... +70 °C	G3/4, G1“, G1 1/2“, G2 1/4“, Aluminum alloy flange	IP67, IP68

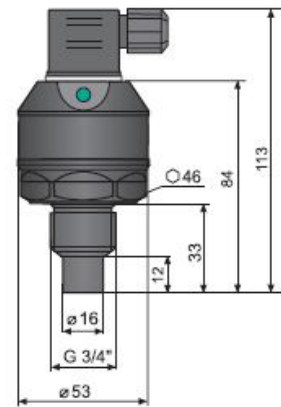

CAPACITIVE LEVEL METERS JLMC-36

Supply voltage	Output type (var. „I“)	Output type (var. „U“)	Accuracy (from measured range)	Temperature range	Temperature range on electrode	Process connection	Protection class
9 ... 36 V DC (for var. „I“) and 11 ... 36 V DC (for var. „U“)	4 ... 20 mA (2-wire)	0 ... 10 V (3-wire)	1 %	-40 °C ... +85 °C	-40 °C ... +200 °C	thread M36x2, G1“, TriClamp	IP65, IP67

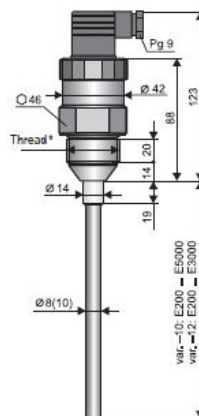
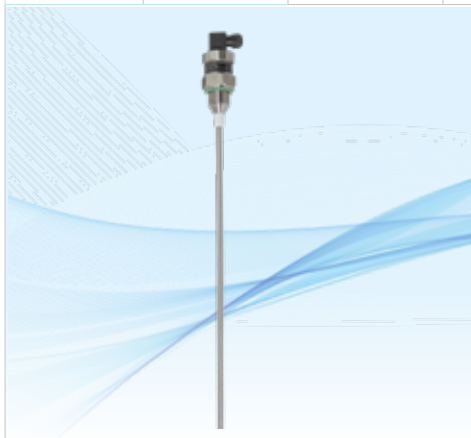

HIGH-FREQUENCY LIMIT LEVEL SENSOR JLSF-35

Supply voltage	Output type	Switching current	Ambient temperature range	Maximum overpressure	Process connection	Protection class
7 ... 34 V DC	PNP, NAMUR	max. 300 mA	-40 °C ... +80 °C	100 bar	Thread G1/2", G3/4", M27x2	IP67, IP68

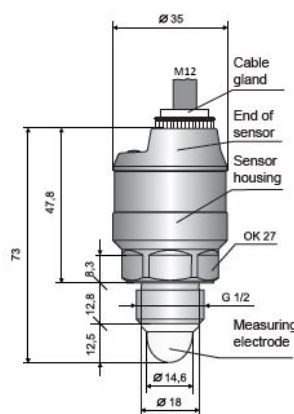

THRU-WALL LEVEL SWITCHES JPLS-25

Supply voltage	Output type	Switching current	Maximum vessel's wall (tube) thickness	Ambient temperature range	Process connection	Protection class
6 ... 30 V DC	PNP, S (current switch)	For pnp max. 100 mA or for s-output 3.3 mA/ 40 mA (min./max.)	8mm (for conductive liquids) or 3mm (for non conductive liquids)	-20 °C ... +80 °C	plastic straps, double sided adhesive layer	IP67

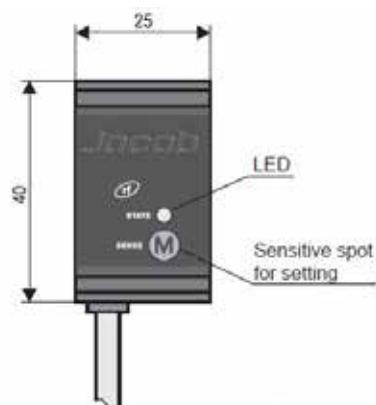

GIULIANA DESSUPOIU
SALES



ROBERT NEUMANN
SALES MANAGER



JÜRGEN OSSWALD
HEAD OF
JACOB ENGINEERED SENSORS



Truly unique
PEOPLE

ERICH PANTEA
HEAD OF SENSOR PRODUCTION



MANJUNATH THEJESWARA
R&D ENGINEER



EDUARD DÜRBACH
QUALITY ASSURANCE



TOUGH

**CHALLENGES
WANTED!**



Tailor-made Level Measurement Technology

Jacob
Connected by ambition